



## *moody cvf1*

### Category

D) Lighting Controllers - moody wall panel

### Description

Wall mount dynamic effects panel controller for a zone of RGB with built-in CV dimmer & illuminated rotary control



### Mechanical

- Housing: UK '1-Gang' Style Panel
- Fascia plate (buy separately): Compatible with 'Scolmore definity click' range
- Overall Dimensions: 86mm (H) x 86mm (W) x 40mm (D)
- Depth behind mounting: 15.2mm
- Mounting: UK '1-Gang' Back Box 35mm (supplied)
- Mounting screw centres: 60.6mm
- Mass: 0.11kg
- Country of Manufacture: United Kingdom

### Power & Electrical

- Input Voltage: 12 to 24 VDC
- Input Connector: (1) 2-pin Screw Terminal DC Voltage Input
- 0.2-1.5mm<sup>2</sup> (30-16AWG) solid conductors
- 0.2-1.0mm<sup>2</sup> (30-16AWG) stranded conductors
- Input Power (max): 500mW plus LED load
- Duty Cycle: 100% @ 25°C

### Environmental

- Operating Temperature: 0°C to 40°C
- Storage Temperature: -10°C to +50°C
- Operating Relative Humidity (max): 80% Non-Condensing
- IP Rating: IP20 Indoor Use Only
- Certification: CE, WEEE, RoHS
- Warranty: 2 Year (Return to Base)

### User Interface / Indication

- (1) Rotary dial for overall intensity control with push on/off
- LED indication: shows overall intensity and real-time colour

### Control

- Colour control: 1 RGB zone
- CV modulation: Pulse Width Modulation
- CV Output connector: (1) 5-pin screw terminal
- 0.2-1.5mm<sup>2</sup> (30-16AWG) solid conductors
- 0.2-1.0mm<sup>2</sup> (30-16AWG) stranded conductors
- Output voltage: identical to input (12-24 VDC)
- LED drive current: 5A

### Programming

- (1) Rotary dial with programming mode (enter/exit by holding down for 3 secs)
- Set the hue and saturation of the start colour and end colour
- Set the fade rate for transition between start and end colour
- (1) Rear jumper for programming inhibit

### Package Contents

- moody cvf1
- Back Box

### Ordering Info

Product Code: moody cvf1  
Accessories (not included): PSU



Mounting Drawing

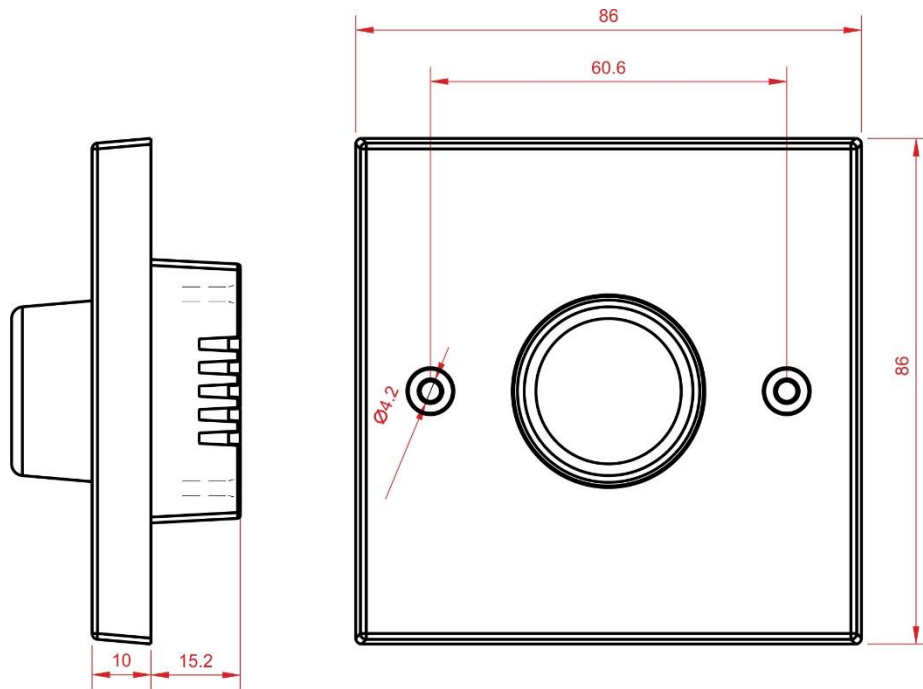

Application Drawing

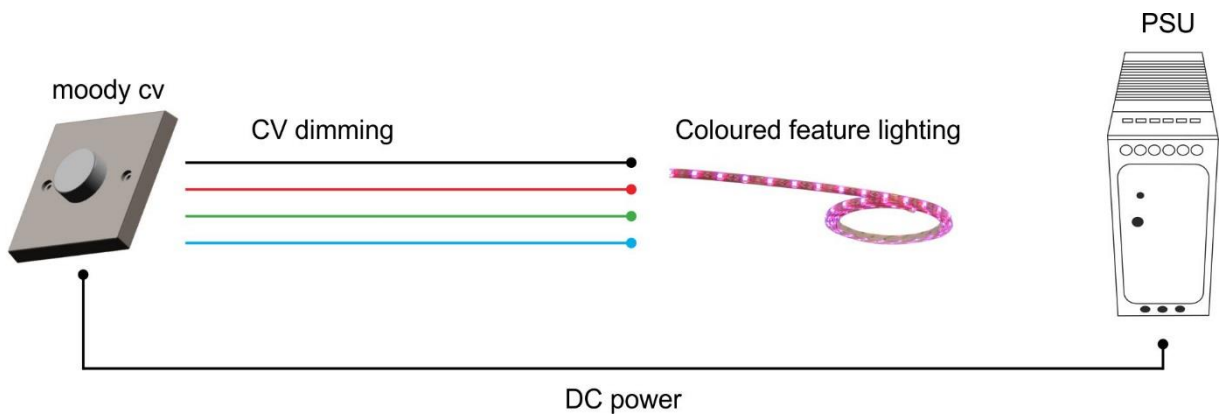

**Artistic Licence Engineering Ltd**

Studio 1, Spectrum House  
32-34 Gordon House Road  
London, NW5 1LP  
United Kingdom

Telephone +44 (0)20 8863 4515  
Fax +44 (0)20 8426 0551  
Email: [Sales@ArtisticLicence.com](mailto:Sales@ArtisticLicence.com)  
[www.ArtisticLicence.com](http://www.ArtisticLicence.com)

Customer support and knowledge base:  
[www.ArtisticLicence.com/support.html](http://www.ArtisticLicence.com/support.html)

All products are covered from date of purchase by a two-year return to base warranty.

Due to our policy of continuing product improvement, specifications are subject to change without notice.

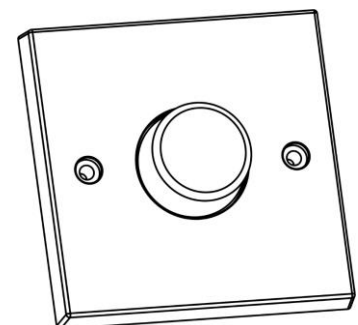

**Artistic Licence**

moody cvf1