



moody f1

Category

D) Lighting Controllers - moody wall panel

Description

Wall mount DALI & DMX dynamic effects panel controller for a zone of RGB with illuminated rotary control



Mechanical

- Housing: UK '1-Gang' Style Panel
- Fascia plate (buy separately): Compatible with 'Scolmore definity click' range
- Overall Dimensions: 86mm (H) x 86mm (W) x 40mm (D)
- Depth behind mounting: 15.2mm
- Mounting: UK '1-Gang' Back Box 35mm (supplied)
- Mounting screw centres: 60.6mm
- Mass: 0.11kg
- Country of Manufacture: United Kingdom

Power & Electrical

- Input Voltage: 9 to 24 VDC
- Input Connector: (1) 2-pin Screw Terminal DC Voltage Input
 - 0.2-1.5mm² (30-16AWG) solid conductors
 - 0.2-1.0mm² (30-16AWG) stranded conductors
- Input Power (max): 500mW
- Duty Cycle: 100% @ 25°C

Environmental

- Operating Temperature: 0°C to 40°C
- Storage Temperature: -10°C to +50°C
- Operating Relative Humidity (max): 80% Non-Condensing
- IP Rating: IP20 Indoor Use Only
- Certification: CE, WEEE, RoHS
- Warranty: 2 Year (Return to Base)

User Interface / Indication

- (1) Rotary dial for overall intensity control with push on/off
- LED indication: shows overall intensity and real-time colour

Control / Isolation

- Colour control: 3 DMX channels or 3 DALI groups
- Output Protocols: DMX512-A, DALI
- DMX Output connector: (1) 3-pin screw terminal
 - 0.2-1.5mm² (30-16AWG) solid conductors
 - 0.2-1.0mm² (30-16AWG) stranded conductors
- DMX Output isolation: Ground referenced
- DALI Output connector: (1) 2-pin screw terminal
 - 0.2-1.5mm² (30-16AWG) solid conductors
 - 0.2-1.0mm² (30-16AWG) stranded conductors
- DALI Output isolation: 2kV Opto-isolated

Programming

- (1) Rotary dial with programming mode (enter/exit by holding down for 3 secs)
- Set the hue and saturation of the start colour and end colour
- Set the fade rate for transition between start and end colour
- (1) Rear jumper for programming inhibit

Package Contents

- moody f1
- Back Box

Ordering Info

Product Code: moody f1

Accessories (not included): PSU



Mounting Drawing

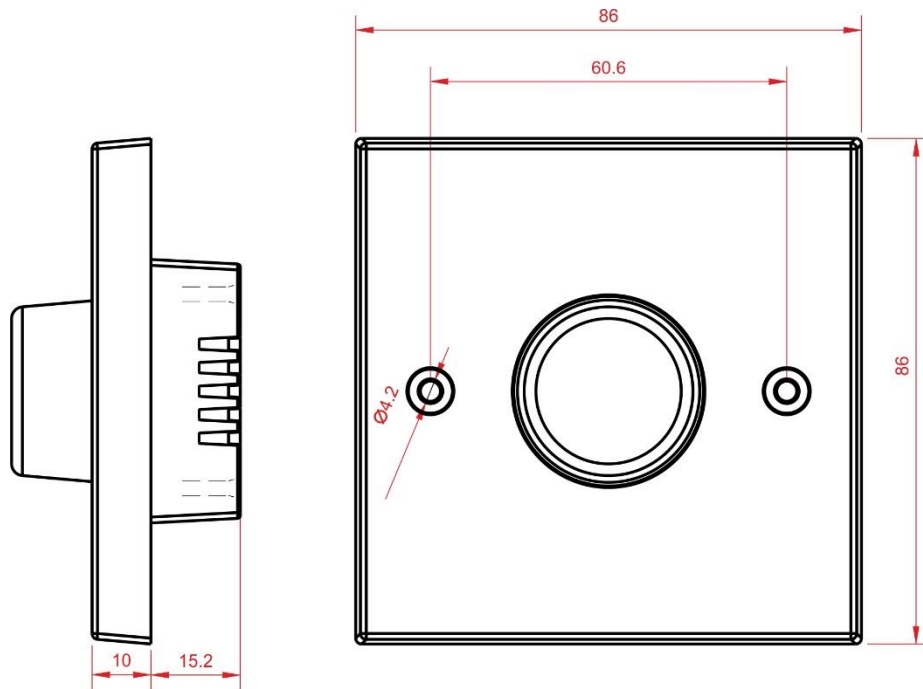

Application Drawing

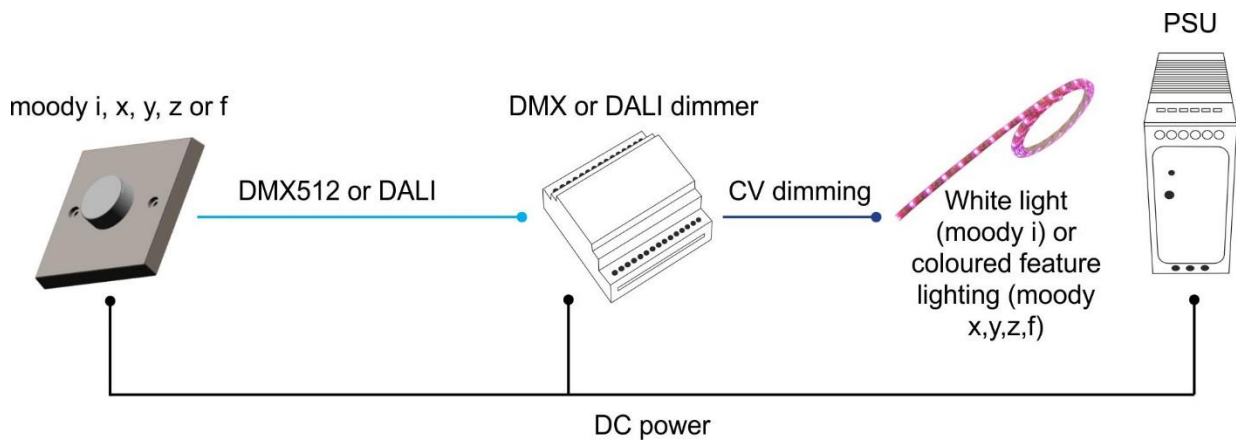

Artistic Licence Engineering Ltd

Studio 1, Spectrum House
32-34 Gordon House Road
London, NW5 1LP
United Kingdom

Telephone +44 (0)20 8863 4515
Fax +44 (0)20 8426 0551
Email: Sales@ArtisticLicence.com
www.ArtisticLicence.com

Customer support and knowledge base:
www.ArtisticLicence.com/support.html

All products are covered from date of purchase by a two-year return to base warranty.

Due to our policy of continuing product improvement, specifications are subject to change without notice.

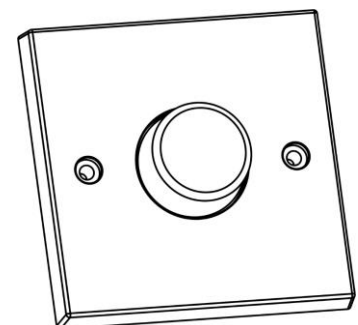

Artistic Licence

moody f1