



## moody y1

### Category

D) Lighting Controllers - moody wall panel

### Description

Wall mount DALI & DMX panel controller for a zone of RGBW with illuminated rotary control



### Mechanical

- Housing: UK '1-Gang' Style Panel
- Fascia plate (buy separately): Compatible with 'Scolmore definity click' range
- Overall Dimensions: 86mm (H) x 86mm (W) x 40mm (D)
- Depth behind mounting: 15.2mm
- Mounting: UK '1-Gang' Back Box 35mm (supplied)
- Mounting screw centres: 60.6mm
- Mass: 0.11kg
- Country of Manufacture: United Kingdom

### Power & Electrical

- Input Voltage: 9 to 24 VDC
- Input Connector: (1) 2-pin Screw Terminal DC Voltage Input
  - 0.2-1.5mm<sup>2</sup> (30-16AWG) solid conductors
  - 0.2-1.0mm<sup>2</sup> (30-16AWG) stranded conductors
- Input Power (max): 500mW

### Environmental

- Operating Temperature: 0°C to 40°C
- Storage Temperature: -10°C to +50°C
- Operating Relative Humidity (max): 80% Non-Condensing
- IP Rating: IP20 Indoor Use Only
- Certification: CE, WEEE, RoHS
- Warranty: 2 Year (Return to Base)

### User Interface / Indication

- (1) Rotary dial for overall intensity control with push on/off
- LED indication: shows overall intensity and colour

### Control / Isolation

- Colour control: 4 DMX channels or 4 DALI groups
- Output Protocols: DMX512-A, DALI
- DMX Output connector: (1) 3-pin screw terminal
  - 0.2-1.5mm<sup>2</sup> (30-16AWG) solid conductors
  - 0.2-1.0mm<sup>2</sup> (30-16AWG) stranded conductors
- DMX Output: PSU referenced
- DALI Output connector: (1) 2-pin screw terminal
  - 0.2-1.5mm<sup>2</sup> (30-16AWG) solid conductors
  - 0.2-1.0mm<sup>2</sup> (30-16AWG) stranded conductors
- DALI Output isolation: 2kV Opto-isolated

### Programming

- (1) Rotary dial with programming mode (enter/exit by holding down for 3 secs)
- Set the hue and white level
- (1) Rear jumper for programming inhibit

### Package Contents

- moody y1
- Back Box

### Ordering Info

Product Code: moody y1

Accessories (not included): PSU



Mounting Drawing

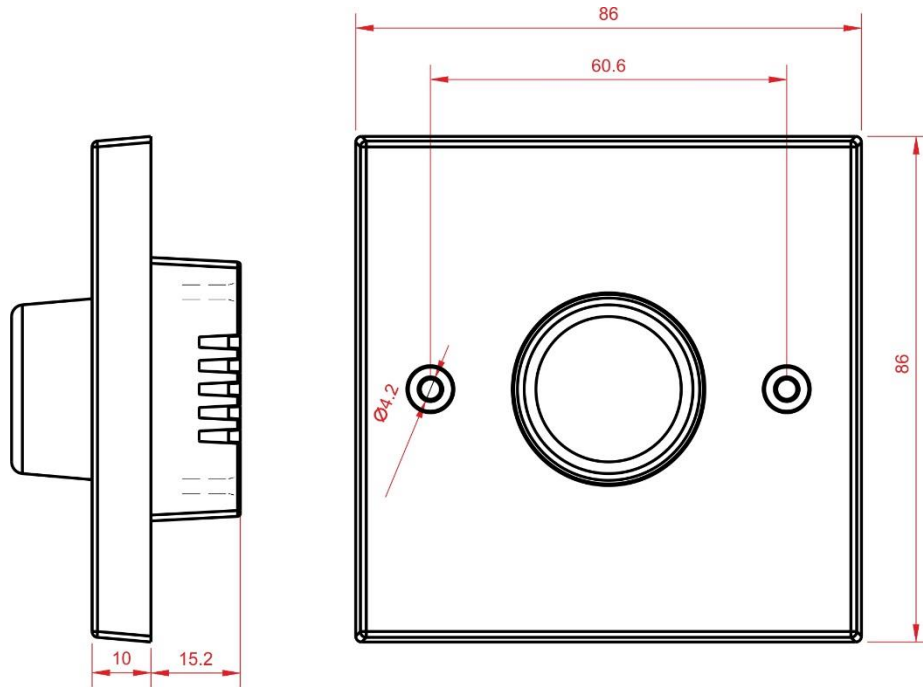

Application Drawing

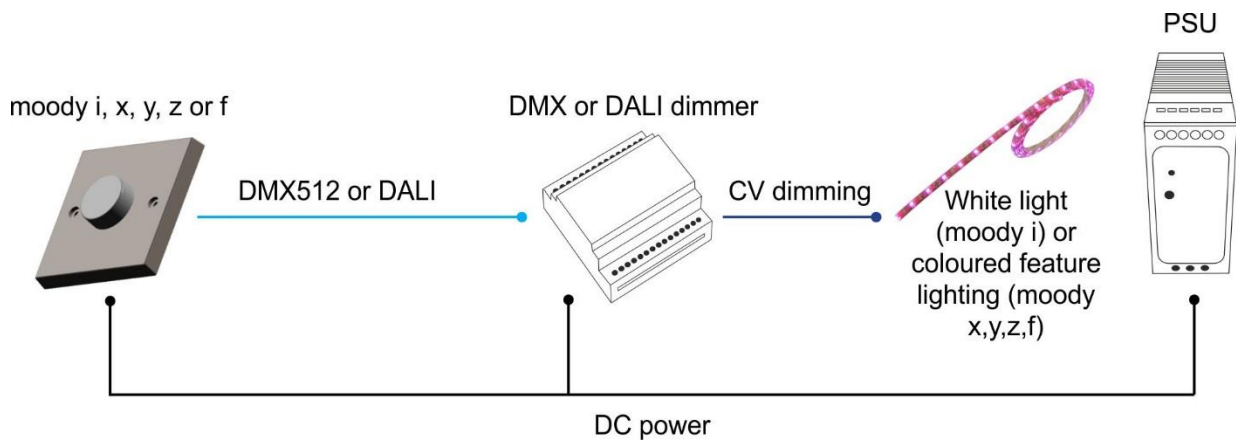

[www.ArtisticLicence.com](http://www.ArtisticLicence.com)

Artistic Licence, The Mould Making Workshop  
Soby Mews, Bovey Tracey, TQ13 9JG, UK

Sales@ArtisticLicence.com  
Support@ArtisticLicence.com  
Tel: +44 (0) 20 8863 4515

*Due to our policy of continuing product improvement specifications are subject to change without notice*

